

### Product descriptions

Line is not just a single profile lighting, but also a system of LED modulars that can be combined to any length and to create almost any configuration imaginable for interior spaces. Besides its compact structure, Line series is even designed with independent direct/indirect lighting output with separate intelligent control of brightness or color temperature, including three different types: anti-glare louvre for free glare, micro-prismatic diffuser for high visual comfort, opal PC diffuser for high efficiency. High-quality materials, Minimalist look, Versatile technology gives Line excellent aesthetics and high performance.

### Technical data

Input	AC220V
Power consumption	61W
CRI	>90
CCT	Indirect - 2700K-4000K Direct - 2700K-4000K
Beam angle	Indirect - 100° Direct - 64°
Chromaticity tolerance	<3 SDCM
Rated lifetime	50000H (Ta 25°C)
Dimming method	DALI/Wireless
Dimming range	0-100%

### Product features

- Compact, distinctively rectangular aluminium profile
- Direct light guided by high-efficiency LED minicell technology with highly specular reflector; indirect light guided by light-guide panels
- High visual comfort
- DALI/Wireless dimming available
- DALI versions occupy 4 addresses  
Wireless versions occupy 2 addresses
- Single or continuous line available

- Profile - matt white/matt black  
Louvre – specular silver/specular black

### Luminous intensity distribution curve

Indirect - LED 12W 1300lm 2700+4000K  
Direct - LED 38W 3900lm 2700+4000K

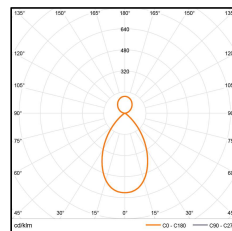

L/m	1.2
W/m	0.8
H/m	1.5 1.2
Ēm/lx	745 1011
QTY	2 2

L: length of desk  
W: width of desk  
H: height of luminaire to desk  
Ēm: average illuminance on desk  
(only for direct lighting)

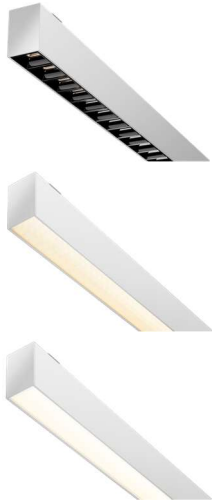

Series	Length	Direct	Indirect	Color	Install
LAG	565mm	• Louvre	• LGP	15/16/25/26	Pendant
	1125mm	• Louvre	• LGP	15/16/25/26	Pendant
	1685mm	• Louvre	• LGP	15/16/25/26	Pendant
	2245mm	• Louvre	• LGP	15/16/25/26	Pendant
LVC	565mm	• MP	• LGP	01/02	Pendant
	1125mm	• MP	• LGP	01/02	Pendant
	1685mm	• MP	• LGP	01/02	Pendant
	2245mm	• MP	• LGP	01/02	Pendant
LHE	565mm	• PC	• LGP	01/02	Pendant
	1125mm	• PC	• LGP	01/02	Pendant
	1685mm	• PC	• LGP	01/02	Pendant
	2245mm	• PC	• LGP	01/02	Pendant

### Mounting restriction

Single or continuous line available. The maximum load current should not exceed 5A.

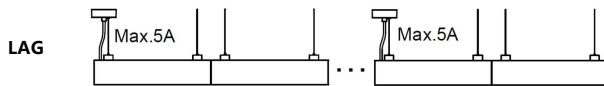

Two luminaires at most could be jointed together

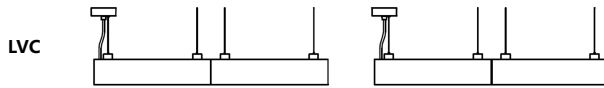

Single or continuous line available. The maximum load current should not exceed 5A.

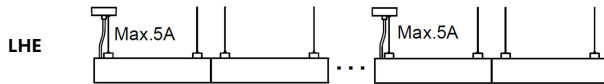

The maximum length of PC: 30 meters

### Installation Info

Pay attention to the following information when or before installation:

Standard length of suspension cord: 1.5 meters;

Standard length of supply cord: 1.7 meters;

DO NOT reduce the quantity of suspension cord when two or more luminaires are jointed together.

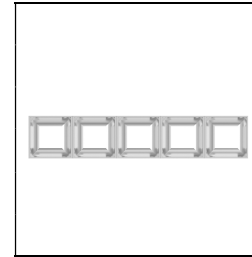

**M9106101.001**  
Louvre  
Specular silver

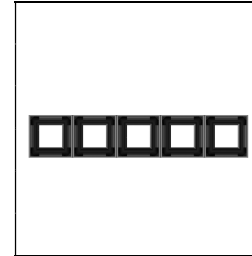

**M9106101.002**  
Louvre  
Specular black

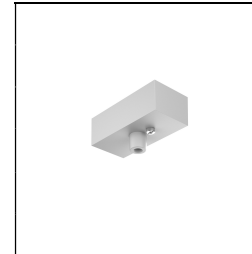

**M9103109.004**  
Junction box  
White

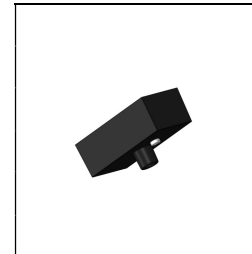

**M9103109.005**  
Junction box  
Black

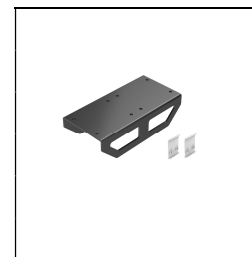

**M9103109.009**  
Junction box with  
side opening  
Black

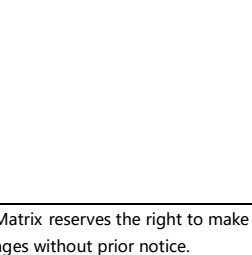

**M9106101.003**  
Connecting  
device