

Product description

System X is a perfect integrated lighting system. Thanks to the advanced lighting technology, X series can achieve ultra compact structure and size, with a recessed, surface or suspended installation, that can perfectly integrate into the building and has minimum impact on architecture. Minimalist extruded aluminum profile, available to do flexible continuous connection into any lengths or shapes. Versatile LED lighting Modules are provided for free combination with tool-free installation for all kinds of applications: General Lighting, Accent Lighting, Wallwashing. X not only means inclusiveness, but also the infinity extensions.

Product features

- Minimalist extruded aluminum profile
- 25mm thick, convenient to be connected as a continuous line via accessories
- Available in length from 0.5m to 2m
- Pendant mounted
- Served as On-off/DALI/Wireless track
- Profile - matt white/black

Technical data

| Art. No. | Description | Type | Length |
|----------|--------------|------------|--------|
| M5103109 | X25TP-LE150 | Live end | 500mm |
| M5103124 | X25TP-C500 | Continuous | 500mm |
| M5103110 | X25TP-LE1000 | Live end | 1000mm |
| M5103111 | X25TP-C1000 | Continuous | 1000mm |
| M5103119 | X25TP-LE2000 | Live end | 2000mm |
| M5103112 | X25TP-C2000 | Continuous | 2000mm |

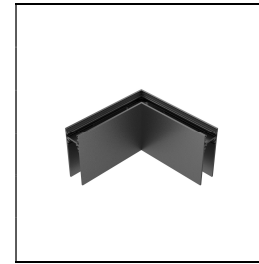
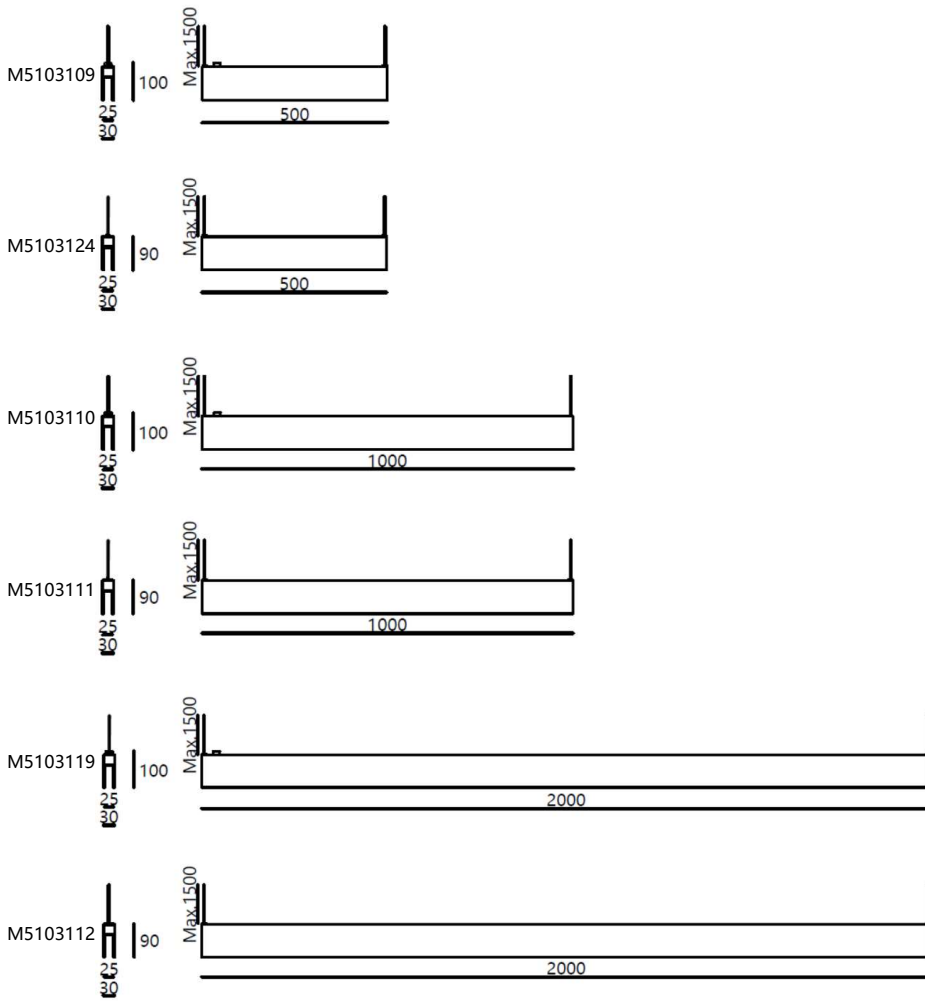

**M9103109.010/
M9103109.001**
90° Corner
Matt white/black

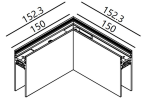

**M9103109.011/
M9103109.002**
T-90° Corner
Matt white/black

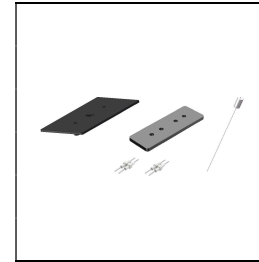
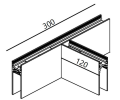

**M9103109.013/
M9103109.003**
Connecting device
Matt white/black

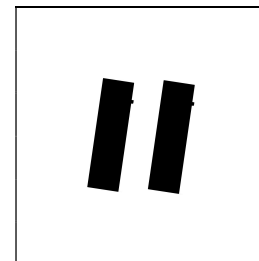

**M9103105.006/
M9103105.004**
End cap
Matt white/black

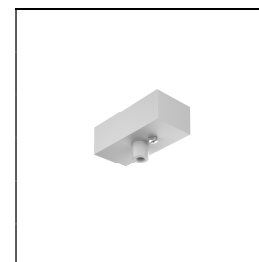

M9103109.004
Junction box
White

M9103109.008
Junction box with side opening
White

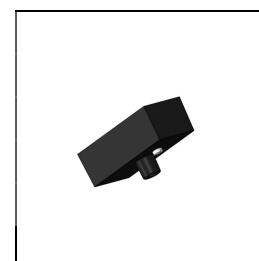

M9103109.005
Junction box
Black

M9103109.009
Junction box with side opening
Black

Power Supply Info

| Type | Dimming | Art. No. | Input | Output | Power | Address | Length |
|-------------------------------|---------|--------------|--------|--------|-------|---------|--------|
| Constant Voltage Power Supply | — | M9102103.005 | AC220V | DC24V | 60W | — | * |
| | — | M9102103.010 | AC220V | DC24V | 100W | — | * |
| | — | M9102103.012 | AC220V | DC24V | 150W | — | * |
| | — | M9102103.013 | AC220V | DC24V | 200W | — | * |
| | — | M9102103.014 | AC220V | DC24V | 240W | — | * |

*Maximum length allowed for interconnection of one single power supply :

$L = 720/P$

L : Maximum length

P : Total load power (not more than 80% of rated power) on track

Installation Info

Pay attention to the following information when or before installation:

Standard length of suspension cord: 1.5 meters;

Standard length of supply cord: 1.7 meters;

Only one suspension cord will be used for the interconnection area.

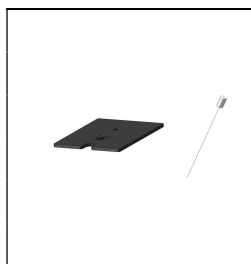

M9103109.006

B-type
connection

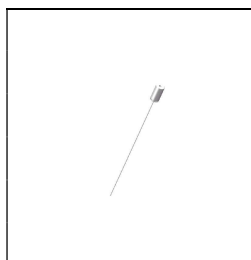

M9103109.007

Suspension cord